

Hardware

- Solenoid spring swivel
- In-line swivel
- Solenoid end cap
- Clevis yoke
- Clevis yoke bead chain assemblies
- PVC terminal protector
- Spherical rod end
- Connectors



Solenoid Spring Swivel

- Provides a 12° rotational movement to compensate for minor misalignment between solenoid and linkage, and allows up to .25" overtravel
- Male and female connectors rotate 360° for easy installation
- "L" dimension 3.0" when using 1/4-28 or M6 male; 3.25" when using 5/16-24 male

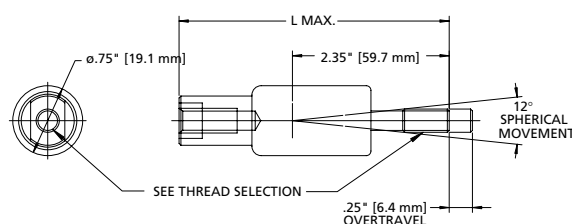

| ORDER NO. | Solenoid Model No. | Optional Return Spring |
|--------------------------|--------------------|------------------------|
| SA-3157 - () () | 1502-1504-1753 | No |
| SA-3158 - () () | 1502-1504-1753 | Yes |
| SA-3159 - () () | 1751-2001-2003 | No |
| SA-3160 - () () | 1751-2001-2003 | Yes |

Male End of Swivel
Thread Selection

A
1/4-28

C
5/16-24

E
M6

Female End of Swivel
Thread Selection

B
1/4-28

D
5/16-24

F
M6

When you order: You will need to provide the male and female swivel thread selection

In-line Swivel

Compensates for possible misalignment between rigid linkage and solenoid plunger

| ORDER NO. | Mounting Thread |
|----------------|-----------------|
| SA-4049 | 1/4-28 |
| SA-4050 | M6 x 1 |

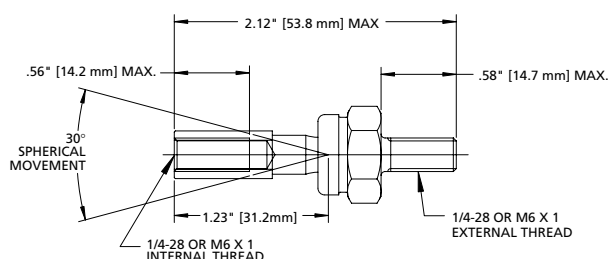

Solenoid End Cap

- Hypalon® rubber end cap thoroughly seals solenoid from contaminants such as water, oil, chemicals and salts
- Sized for 1500, 1750, and 2000 series solenoids

®Hypalon is a registered trademark of DuPont Dow Elastomers.

| ORDER NO. | Solenoid Model No. |
|----------------|--------------------|
| SE-5601 | 1500 Series |
| SE-5614 | 1750 Series |
| SE-5559 | 2000 Series |

Clevis Yoke

For use in customer designed linkage assemblies

| ORDER NO. | Mounting Thread |
|-----------|-----------------|
| SA-0008-A | 1/4-28 |

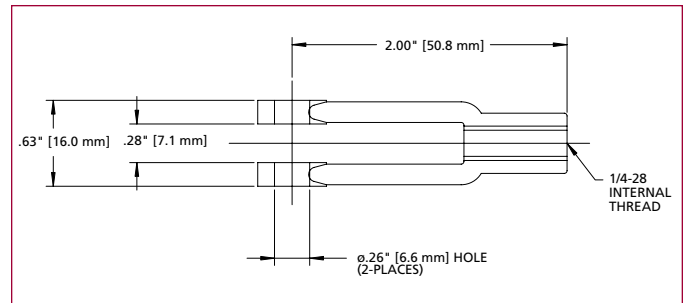

Clevis Yoke Bead Chain Assemblies

Used whenever a flexible connection is required, such as pulling a throttle lever on a gasoline engine

| ORDER NO. | Mounting Thread |
|-----------|-----------------|
| SA-0293-B | 1/4-28 |

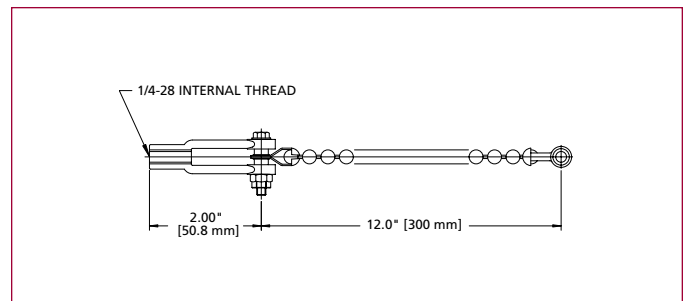

PVC Terminal Protector

- For internally switched solenoids with terminals
- Fits over solenoid cap to protect terminals from accidental shorting
- Available in end or side termination

| ORDER NO. | Termination |
|------------|-------------|
| SA-2968 | End |
| SA-2968-UK | Side |

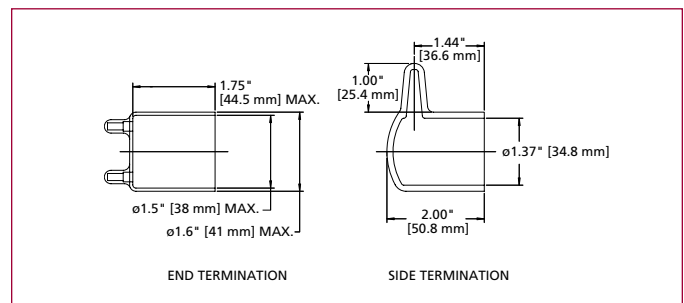

Spherical Rod End

- Heavy duty, low friction, nylon race ball joints for connecting solenoid linkage to fuel pump levers
- Available in male and female options

| ORDER NO. | Body | Stud |
|-----------|-----------------|-----------------|
| SA-4280 | Internal 1/4-28 | None |
| SA-4188 | Internal 1/4-28 | External 1/4-28 |
| SA-4232 | External 1/4-28 | External 1/4-28 |

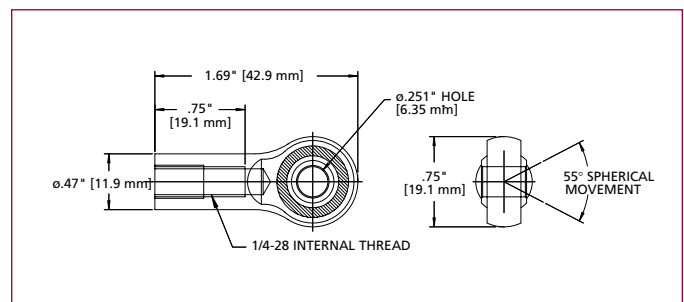

Connectors

- For externally switched solenoids with leads
- Special materials and seals are used to allow the connector to withstand extreme temperature and moisture conditions
- For ordering information contact Woodward

